



RoHS compliant
850 nm Multi-mode Transceiver, 2km
Small Form Pluggable (SFP), with Diagnostic Monitoring
2Mbps C37.94



Features

- IEEE C37.94 application
- RoHS compliant
- Compliant with SFF8472 diagnostic monitoring interface
- Duplex LC connector
- Single power supply 3.3V
- Hot Pluggable
- Class 1 laser product complies with EN 60825-1

Ordering Information

PART NUMBER	INPUT/OUTPUT	SIGNAL DETECT	VOLTAGE	TEMPERATURE	DISTANCE
LM28-A3C-TC-N-EC	AC/AC	TTL	3.3V	0°C to 70 °C	2Km
LM28-A3C-TK-N-EC	AC/AC	TTL	3.3V	-10°C to 85 °C	2Km
LM28-A3C-TI-N-EC	AC/AC	TTL	3.3V	-40°C to 85 °C	2Km

Diagnostics

Parameter	Range	Accuracy	Unit	Calibration
Temperature	-40 to 85	± 3	°C	Internal
Voltage	3.1 to 3.5	± 0.1	V	
Bias Current	0 to 16	± 10%	mA	
TX Power	-19 to -11	± 3 dB	dBm	
RX Power	-32 to -8	± 3 dB	dBm	



RoHS compliant
850 nm Multi-mode Transceiver, 2km
Small Form Pluggable (SFP), with Diagnostic Monitoring
2Mbps C37.94

Absolute Maximum Ratings

PARAMETER	SYMBOL	MIN	MAX	UNITS	NOTE
Storage Temperature	T_S	-40	85	°C	
Supply Voltage	V_{CC}	-0.5	4.0	V	
Input Voltage	V_{IN}	-0.5	V_{CC}	V	

Recommended Operating Conditions

PARAMETER	SYMBOL	MIN	MAX	UNITS	NOTE
Operating Case Temperature	T_C	0	70	°C	
		-10	85		
		-40	85		
Supply Voltage	V_{CC}	3.1	3.5	V	
Supply Current	$I_{TX} + I_{RX}$	---	150	mA	



RoHS compliant
850 nm Multi-mode Transceiver, 2km
Small Form Pluggable (SFP), with Diagnostic Monitoring
2Mbps C37.94

Transmitter Electro-optical Characteristics

PARAMETER	SYMBOL	MIN	TYP.	MAX	UNITS	NOTE
Output Optical Power 62.5/125 μ m fiber	P_{out}	-19	---	-11	dBm	Average
Output Optical Power 50/125 μ m fiber	P_{out}	-23	---	-11	dBm	Average
Extinction Ratio	ER	12	---	---	dB	
Center Wavelength	λ_C	830	850	860	nm	
Spectral Width (RMS)	$\Delta\lambda$	---	---	1	nm	
Max. P_{out} TX-DISABLE Asserted	P_{OFF}	---	---	-45	dBm	
Differential Input Voltage	V_{DIFF}	0.4	---	2.0	V	



RoHS compliant
850 nm Multi-mode Transceiver, 2km
Small Form Pluggable (SFP), with Diagnostic Monitoring
2Mbps C37.94

Receiver Electro-optical Characteristics

PARAMETER	SYMBOL	MIN	TYP.	MAX	UNITS	NOTE
Optical Input Power-maximum	P_{IN}	-8	---	---	dBm	PRBS7, BER < 10^{-10}
Optical Input Power-minimum (Sensitivity)	P_{IN}	---	---	-32	dBm	PRBS7, BER < 10^{-10}
Operating Center Wavelength	λ_C	790	---	870	nm	
LOS-Deasserted	P_A	---	---	-32	dBm	
LOS-Asserted	P_D	-45	---	---	dBm	
Differential Output Voltage	V_{DIFF}	0.6	---	1.8	V	
Receiver Loss of Signal Output Voltage-Low	RX_LOS_L	0	---	0.5	V	
Receiver Loss of Signal Output Voltage-High	RX_LOS_H	2.4	---	V_{CC}	V	



RoHS compliant
850 nm Multi-mode Transceiver, 2km
Small Form Pluggable (SFP), with Diagnostic Monitoring
2Mbps C37.94

Dimensions

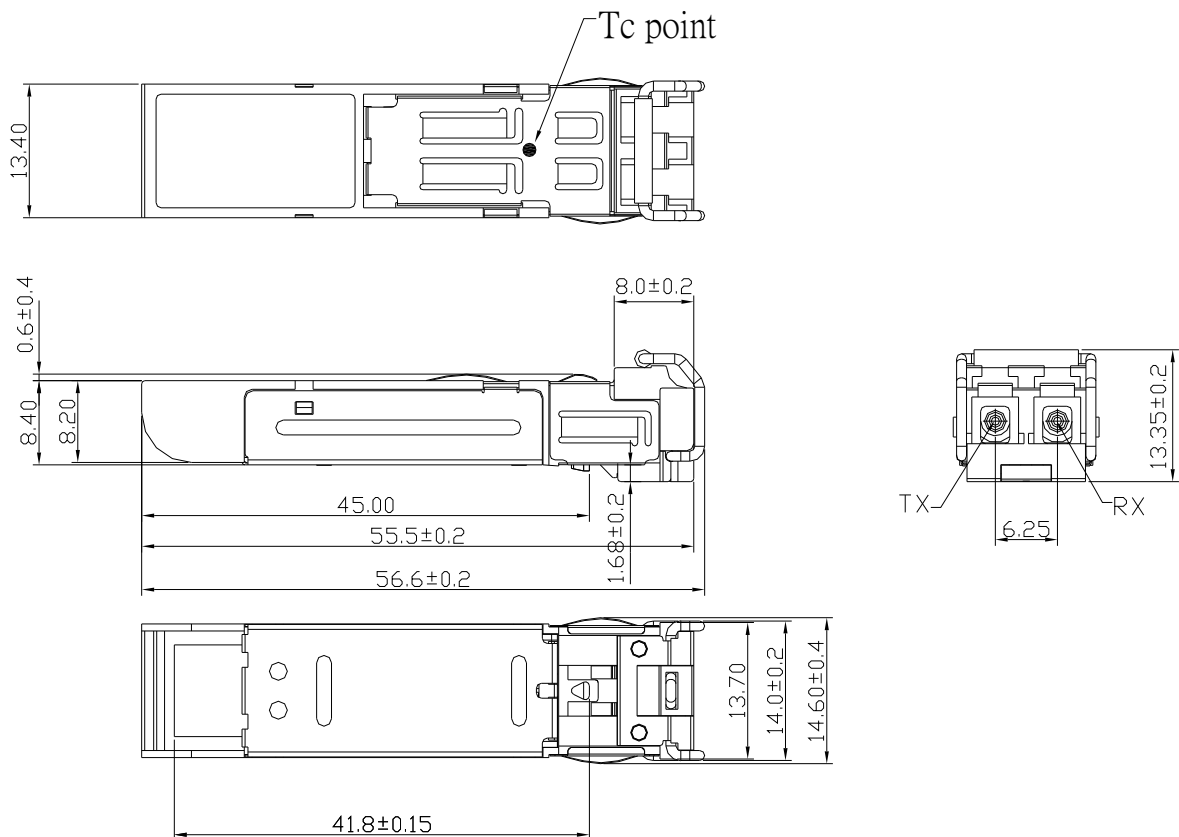

DIMENSIONS ARE IN MILLIMETERS

ALL DIMENSIONS ARE ± 0.1mm UNLESS OTHERWISE SPECIFIED

Unit: mm

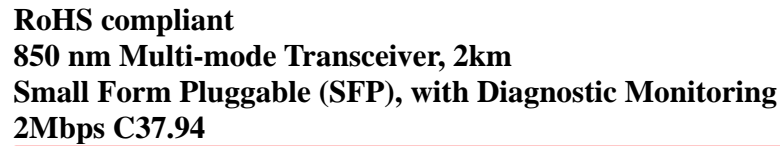

This is a detailed mechanical drawing of a PCB edge connector. The drawing includes the following dimensions and callouts:

- Overall Dimensions:**
 - Width: 42.30
 - Height: 16.25
- Pin Dimensions and Spacing:**
 - Pin 1: 10X $\phi 1.05 \pm 0.01$ (Callout 1)
 - Pin 2: $\phi 0.85 \pm 0.05$ (Callout 2)
 - Pin 3: 9X $\phi 0.95 \pm 0.05$ (Callout 3)
 - Pin 4: 2.00X11 (Callout 4)
 - Pin 5: 2.00X11 (Callout 5)
 - Pin 6: 2.00X11 (Callout 6)
 - Pin 7: 2.00X11 (Callout 7)
 - Pin 8: 2.00X11 (Callout 8)
 - Pin 9: 2.00X11 (Callout 9)
 - Pin 10: 2.00X11 (Callout 10)
 - Pin 11: 2.00X11 (Callout 11)
 - Pin 12: 2.00X11 (Callout 12)
 - Pin 13: 2.00X11 (Callout 13)
 - Pin 14: 2.00X11 (Callout 14)
 - Pin 15: 2.00X11 (Callout 15)
 - Pin 16: 2.00X11 (Callout 16)
 - Pin 17: 2.00X11 (Callout 17)
 - Pin 18: 2.00X11 (Callout 18)
 - Pin 19: 2.00X11 (Callout 19)
 - Pin 20: 2.00X11 (Callout 20)
 - Pin 21: 2.00X11 (Callout 21)
 - Pin 22: 2.00X11 (Callout 22)
 - Pin 23: 2.00X11 (Callout 23)
 - Pin 24: 2.00X11 (Callout 24)
 - Pin 25: 2.00X11 (Callout 25)
 - Pin 26: 2.00X11 (Callout 26)
 - Pin 27: 2.00X11 (Callout 27)
 - Pin 28: 2.00X11 (Callout 28)
 - Pin 29: 2.00X11 (Callout 29)
 - Pin 30: 2.00X11 (Callout 30)
 - Pin 31: 2.00X11 (Callout 31)
 - Pin 32: 2.00X11 (Callout 32)
 - Pin 33: 2.00X11 (Callout 33)
 - Pin 34: 2.00X11 (Callout 34)
 - Pin 35: 2.00X11 (Callout 35)
 - Pin 36: 2.00X11 (Callout 36)
 - Pin 37: 2.00X11 (Callout 37)
 - Pin 38: 2.00X11 (Callout 38)
 - Pin 39: 2.00X11 (Callout 39)
 - Pin 40: 2.00X11 (Callout 40)
 - Pin 41: 2.00X11 (Callout 41)
 - Pin 42: 2.00X11 (Callout 42)
 - Pin 43: 2.00X11 (Callout 43)
 - Pin 44: 2.00X11 (Callout 44)
 - Pin 45: 2.00X11 (Callout 45)
 - Pin 46: 2.00X11 (Callout 46)
 - Pin 47: 2.00X11 (Callout 47)
 - Pin 48: 2.00X11 (Callout 48)
 - Pin 49: 2.00X11 (Callout 49)
 - Pin 50: 2.00X11 (Callout 50)
 - Pin 51: 2.00X11 (Callout 51)
 - Pin 52: 2.00X11 (Callout 52)
 - Pin 53: 2.00X11 (Callout 53)
 - Pin 54: 2.00X11 (Callout 54)
 - Pin 55: 2.00X11 (Callout 55)
 - Pin 56: 2.00X11 (Callout 56)
 - Pin 57: 2.00X11 (Callout 57)
 - Pin 58: 2.00X11 (Callout 58)
 - Pin 59: 2.00X11 (Callout 59)
 - Pin 60: 2.00X11 (Callout 60)
 - Pin 61: 2.00X11 (Callout 61)
 - Pin 62: 2.00X11 (Callout 62)
 - Pin 63: 2.00X11 (Callout 63)
 - Pin 64: 2.00X11 (Callout 64)
 - Pin 65: 2.00X11 (Callout 65)
 - Pin 66: 2.00X11 (Callout 66)
 - Pin 67: 2.00X11 (Callout 67)
 - Pin 68: 2.00X11 (Callout 68)
 - Pin 69: 2.00X11 (Callout 69)
 - Pin 70: 2.00X11 (Callout 70)
 - Pin 71: 2.00X11 (Callout 71)
 - Pin 72: 2.00X11 (Callout 72)
 - Pin 73: 2.00X11 (Callout 73)
 - Pin 74: 2.00X11 (Callout 74)
 - Pin 75: 2.00X11 (Callout 75)
 - Pin 76: 2.00X11 (Callout 76)
 - Pin 77: 2.00X11 (Callout 77)
 - Pin 78: 2.00X11 (Callout 78)
 - Pin 79: 2.00X11 (Callout 79)
 - Pin 80: 2.00X11 (Callout 80)
 - Pin 81: 2.00X11 (Callout 81)
 - Pin 82: 2.00X11 (Callout 82)
 - Pin 83: 2.00X11 (Callout 83)
 - Pin 84: 2.00X11 (Callout 84)
 - Pin 85: 2.00X11 (Callout 85)
 - Pin 86: 2.00X11 (Callout 86)
 - Pin 87: 2.00X11 (Callout 87)
 - Pin 88: 2.00X11 (Callout 88)
 - Pin 89: 2.00X11 (Callout 89)
 - Pin 90: 2.00X11 (Callout 90)
 - Pin 91: 2.00X11 (Callout 91)
 - Pin 92: 2.00X11 (Callout 92)
 - Pin 93: 2.00X11 (Callout 93)
 - Pin 94: 2.00X11 (Callout 94)
 - Pin 95: 2.00X11 (Callout 95)
 - Pin 96: 2.00X11 (Callout 96)
 - Pin 97: 2.00X11 (Callout 97)
 - Pin 98: 2.00X11 (Callout 98)
 - Pin 99: 2.00X11 (Callout 99)
 - Pin 100: 2.00X11 (Callout 100)
 - Pin 101: 2.00X11 (Callout 101)
 - Pin 102: 2.00X11 (Callout 102)
 - Pin 103: 2.00X11 (Callout 103)
 - Pin 104: 2.00X11 (Callout 104)
 - Pin 105: 2.00X11 (Callout 105)
 - Pin 106: 2.00X11 (Callout 106)
 - Pin 107: 2.00X11 (Callout 107)
 - Pin 108: 2.00X11 (Callout 108)
 - Pin 109: 2.00X11 (Callout 109)
 - Pin 110: 2.00X11 (Callout 110)
 - Pin 111: 2.00X11 (Callout 111)
 - Pin 112: 2.00X11 (Callout 112)
 - Pin 113: 2.00X11 (Callout 113)
 - Pin 114: 2.00X11 (Callout 114)
 - Pin 115: 2.00X11 (Callout 115)
 - Pin 116: 2.00X11 (Callout 116)
 - Pin 117: 2.00X11 (Callout 117)
 - Pin 118: 2.00X11 (Callout 118)
 - Pin 119: 2.00X11 (Callout 119)
 - Pin 120: 2.00X11 (Callout 120)
 - Pin 121: 2.00X11 (Callout 121)
 - Pin 122: 2.00X11 (Callout 122)
 - Pin 123: 2.00X11 (Callout 123)
 - Pin 124: 2.00X11 (Callout 124)
 - Pin 125: 2.00X11 (Callout 125)
 - Pin 126: 2.00X11 (Callout 126)
 - Pin 127: 2.00X11 (Callout 127)
 - Pin 128: 2.00X11 (Callout 128)
 - Pin 129: 2.00X11 (Callout 129)
 - Pin 130: 2.00X11 (Callout 130)
 - Pin 131: 2.00X11 (Callout 131)
 - Pin 132: 2.00X11 (Callout 132)
 - Pin 133: 2.00X11 (Callout 133)
 - Pin 134: 2.00X11 (Callout 134)
 - Pin 135: 2.00X11 (Callout 135)
 - Pin 136: 2.00X11 (Callout 136)
 - Pin 137: 2.00X11 (Callout 137)
 - Pin 138: 2.00X11 (Callout 138)
 - Pin 139: 2.00X11 (Callout 139)
 - Pin 140: 2.00X11 (Callout 140)
 - Pin 141: 2.00X11 (Callout 141)
 - Pin 142: 2.00X11 (Callout 142)
 - Pin 143: 2.00X11 (Callout 143)
 - Pin 144: 2.00X11 (Callout 144)
 - Pin 145: 2.00X11 (Callout 145)
 - Pin 146: 2.00X11 (Callout 146)
 - Pin 147: 2.00X11 (Callout 147)
 - Pin 148: 2.00X11 (Callout 148)
 - Pin 149: 2.00X11 (Callout 149)
 - Pin 150: 2.00X11 (Callout 150)
 - Pin 151: 2.00X11 (Callout 151)
 - Pin 152: 2.00X11 (Callout 152)
 - Pin 153: 2.00X11 (Callout 153)
 - Pin 154: 2.00X11 (Callout 154)



- 1.PADS AND VIAS ARE CHASSIS GROUND
- 2.THROUGH HOLES, PLATING OPTIONAL
- 3.HATCHED AREA DENOTES COMPONENT AND TRACE KEEPOUT(EXCEPT CHASSIS GROUND)
- 4.AREA DENOTES COMPONENT KEEPOUT (TRACES ALLOWED)

DIMENSIONS ARE IN MILLIMETERS

Unit: mm

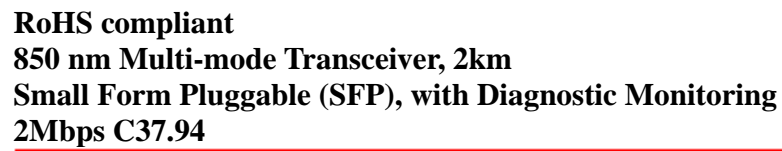

Technical drawing of the PCB assembly showing top and side views with dimensions:

- Top View Dimensions:**
 - Overall width: 1.7 ± 0.9
 - Distance from right edge to center of hole pattern: 41.73 ± 0.5
 - Distance from center of hole pattern to right edge: 3.5 ± 0.3
 - Maximum height of the PCB: 15.0 MAX
- Side View Dimensions:**
 - Maximum height of the cage assembly: 9.8 MAX
 - Reference height for the bezel: 11.0 REF.
- Labels:**
 - PCB (Pointing to the main board)
 - BEZEL (Pointing to the front cover)
 - CAGE ASSEMBLY (Pointing to the internal structure)

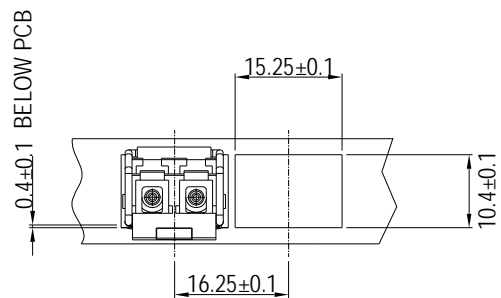

PCB

Unit: mm



RoHS compliant
850 nm Multi-mode Transceiver, 2km
Small Form Pluggable (SFP), with Diagnostic Monitoring
2Mbps C37.94

Pin Assignment

Pin-Out

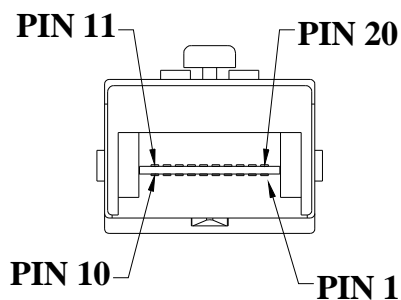

Pin	Signal Name	Description
1	T_{GND}	Transmit Ground
2	TX_FAULT	Transmit Fault
3	$TX_DISABLE$	Transmit Disable
4	$MOD_DEF (2)$	SDA Serial Data Signal
5	$MOD_DEF (1)$	SCL Serial Clock Signal
6	$MOD_DEF (0)$	TTL Low
7	$RATE_SELECT$	Open Circuit
8	RX_LOS	Receiver Loss of Signal, TTL High, open collector
9	R_{GND}	Receiver Ground
10	R_{GND}	Receiver Ground
11	R_{GND}	Receiver Ground
12	$RX-$	Receive Data Bar, Differential , ac coupled
13	$RX+$	Receive Data, Differential , ac coupled
14	R_{GND}	Receiver Ground
15	V_{CCR}	Receiver Power Supply
16	V_{CCT}	Transmitter Power Supply
17	T_{GND}	Transmitter Ground
18	$TX+$	Transmit Data, Differential , ac coupled
19	$TX-$	Transmit Data Bar, Differential , ac coupled
20	T_{GND}	Transmitter Ground